

SHARP

ER-A280F

Electronic Cash Register



Working Smart—
There's No Better Way
to Grow a Business



- Large, easy-to-view multi-line LCD operator display (192 x 80 dots) with tilt mechanism
- Standard SD card slot for data backup
- 4 built-in RS232 ports for system expansion
- 2,000 standard PLUs, expandable to 16,000

Large Multi-Line LCD for User-Friendly Operation

The backlit, six- or 10-line*, 192 x 80-dot LCD operator display featured on the ER-A280F provides high visibility. It can display up to 24 alphanumeric characters, allowing clerks to view items, prices, and other information even in low-light environments. And for better viewing, the operator display can be tilted to an angle. The ER-A280F also features an easy-to-read, 10-digit LED customer display that ensures customer confidence.



Operator display



Customer display

* Six lines for sales registration, 10 lines for reporting/programming

Scanner-Ready and On-Line Capability with Four RS232 Interface Ports

The ER-A280F comes standard with four RS232 interface ports for system expansion, making it easy to upload sales figures to a PC for efficient data management and analysis. An optional scanner can also be connected for the added advantage of speedy, accurate barcode entry.



Data Backup with SD Card Slot

The ER-A280F is equipped with an SD card slot. SD cards can be used to back up various kinds of data, including daily sales and Electronic Journal data.

Note: SD cards are not included. Consult your Sharp dealer for details.

 The SD logo is a trademark of the SD Card Association.



Electronic Journal

The ER-A280F features an Electronic Journal function that can store up to 9,000 lines of transaction data electronically, thus helping to conserve paper and reduce costs. And for easy reference, the Electronic Journal View function displays transaction data from previous entries.

Specifications

Model	ER-A280F	
Display	Operator	Monochrome LCD with backlight 192 x 80 dots
	Customer	10-digit, 7-segment LED
Printer	Type	1-station, drop-in, thermal
	Digits	30 digits
	Paper width	58 mm
	Speed	Approx. 15 lines/sec.
Drawer	Bill	4 compartments
	Coin	8 compartments
Keyboard	Type	Flat key
	No. of keys	70
Interface	Four RS232 ports (2 x 9-pin D-sub, 2 x RJ45) One SD card slot	
Departments	Standard 6	
	Max. 99, 14 groups	
PLUs	Standard 2,000, max. 16,000	
Electronic journal	9,000 lines*	
VAT/tax system	Total 6 rates	
Dimensions (W x D x H) (approx.)	425 x 430 x 230 mm	
Weight (approx.)	12 kg	

* Will be less than 9,000 when using 16,000 PLUs.

Quick Thermal Printer with Graphic Logo Printing

Featuring thermal printing technology, the ER-A280F prints out sales receipts on 58-mm-wide paper at a speedy rate of approximately 15 lines per second. Graphic logos can be printed out as well, helping to further promote your business. Plus, the drop-in paper loading mechanism allows you to change paper rolls quickly and easily.



Quick and Accurate Price Entry

Equipped with 2,000 PLUs (price look-ups), expandable to 16,000, the ER-A280F makes entering pricing information a snap. By simply entering the code for the items being purchased, you can total up sales with accuracy and speed. A total of 99 departments are also available, enabling you to easily track and analyse transactions by product type.

Other Key Features

- Flat keyboard
- 2,000 standard PLUs/EANs (2 price levels), expandable to 16,000 (1 price level)
- Promotion functionality allows up to 30 tables (free item/amount or discount %)
- Drawer (4 bill and 8 coin compartments)
- Up to 99 code-entry clerk keys (20 standard)
- Overlapped clerk system
- Simple GLU (guest look-up) function
- 10 automatic keys
- Tax (VAT) shift function (6 rates)

System Configuration

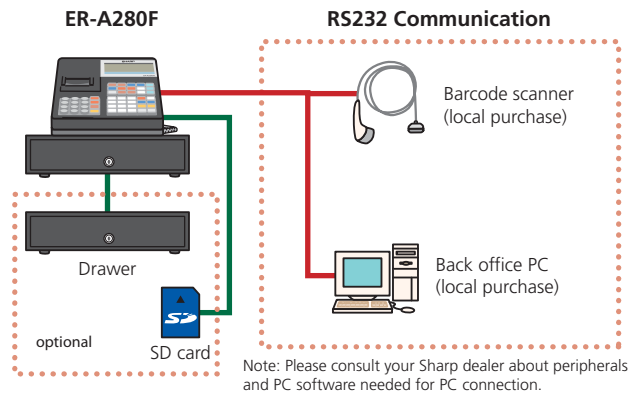

Dimensions (mm)

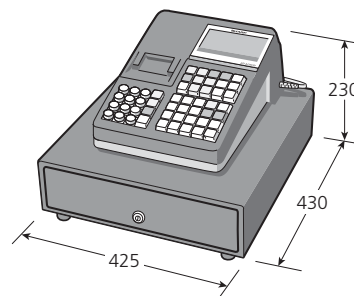

Design and specifications are subject to change without prior notice.

Sharp Corporation of Australia Pty Ltd
 ABN 40 003 039 405
 1 Huntingwood Drive
 Huntingwood NSW 2148
 ph: 02-9830-4600
<http://www.sharp.net.au>

Distributed by:

Sharp Corporation of New Zealand Ltd
 59 Hugo Johnston Drive
 Auckland
 ph: 0-9-573 0111
<http://www.sharp.net.nz>